

1151 ST PAULS PARRISH LN, JOHNS ISLAND, SC
29455, USA

<https://findyourcharleston.com>

1151 St Pauls
Parrish Ln, Johns
Island, SC 29455,
USA



\$369,000

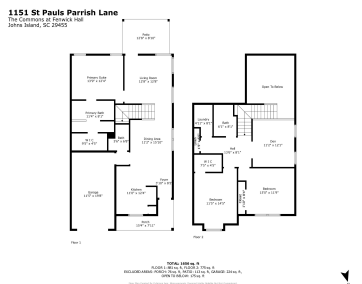

BACK ON THE MARKET AT NO FAULT BY THE SELLER!! Welcome to Your New Home in The Gates of Fenwick Plantation! Discover easy living in this spacious townhome, where lawn maintenance, irrigation, exterior upkeep, insurance, and a termite bond are all taken care of for you through the HOA fee. Enjoy fresh air on your covered [...]



John Rudloff

- 3 beds
- 2 baths
- Single Family Attached
- Residential
- Active
- 1744 sq ft



Basics



MLS ID: 24024714

Category: Residential

Status: Active

Bathrooms: 2 baths

Area, sq ft: 1744 sq ft

Year built: 2007

County Or Parish: Charleston

Date added: Added 7 months ago

Type: Single Family Attached

Bedrooms: 3 beds

Half baths: 1 half bath

Lot size, acres: 0.12 acres

Subdivision Name: The Gates of Fenwick Plantation

MLS Area Major: 23 - Johns Island

Building Details

Stories: 2

Parking Features: 1 Car Garage, Attached, Off Street, Garage Door Opener

Covered Spaces: 1

Construction Materials: Vinyl Siding

Garage Spaces: 1

Roof: Architectural

Amenities & Features

Water Source: Public

Sewer: Public Sewer

Door Features: Some Storm Door(s)

Window Features: Some Storm Wnd/Doors, Window Treatments - Some

Attached Garage Yes/ No: 1

Heating: Forced Air, Natural Gas

Patio & Porch Features: Patio, Covered, Front Porch

Exterior Features: Rain Gutters

Cooling Yes/ No: 1

Cooling: Central Air

Interior Features: Ceiling - Cathedral/Vaulted, Ceiling - Smooth, High Ceilings, Garden Tub/Shower, Walk-In Closet(s), Ceiling Fan(s), Eat-in Kitchen, Family, Entrance Foyer, Great, Loft, Pantry, Separate Dining, Utility

Flooring: Carpet, Ceramic Tile

Hidden Info

List Office MLS Id: 1279

