

1843 RIFLE RANGE RD, MT PLEASANT, SC 29464, USA

<https://findyourcharleston.com>

1843 Rifle Range Rd, Mt Pleasant, SC 29464, USA



\$1,193,745

ELEVATION 2

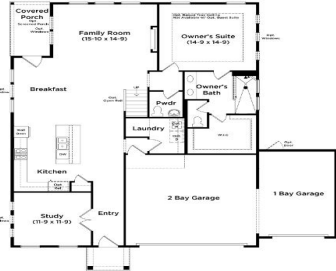

Come build the Lighthouse in the highly anticipated Fiddler Cove Community. Only 16 homesites off of Rifle Range Rd minutes from shopping and the beaches. The Lighthouse features an open concept kitchen open to breakfast area, family room, and screened porch. Features included are first floor owner's suites, 3rd car garage, study and electric fireplace. [...]

- 5 beds
- 3 baths
- Single Family Detached
- Residential
- Active
- 3000 sq ft



Laura Ashfield

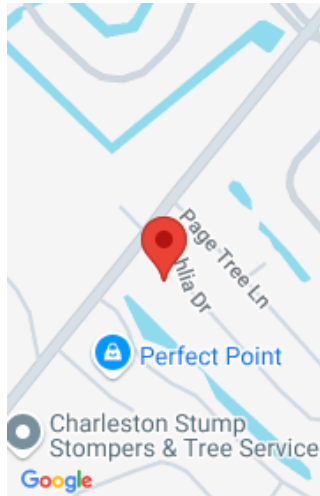

Basics

MLS ID: 24017356 **Date added:** Added 2 months ago
Category: Residential **Type:** Single Family Detached
Status: Active **Bedrooms:** 5 beds
Bathrooms: 3 baths **Half baths:** 1 half bath
Area, sq ft: 3000 sq ft **Lot size, acres:** 0.25 acres
Year built: 2024 **Subdivision Name:** Fiddlers Cove
County Or Parish: Charleston **MLS Area Major:** 42 - Mt Pleasant S of IOP Connector

Building Details

Stories: 2 **Parking Features:** 3 Car Garage, Attached, Garage Door Opener
Entry Location: Ground Level **Covered Spaces:** 3
Construction Materials: Cement Plank **Garage Spaces:** 3
Roof: Architectural, Metal

Amenities & Features

Water Source: Public **Patio & Porch Features:** Front Porch, Screened
Architectural Style: Traditional **Sewer:** Public Sewer
Exterior Features: Lawn Irrigation **Cooling Yes/ No:** 1
Window Features: ENERGY STAR Qualified Windows **Cooling:** Central Air
Attached Garage Yes/ No: 1 **Interior Features:** Ceiling - Smooth, High Ceilings, Kitchen Island, Walk-In Closet(s), Eat-in Kitchen, Family, Entrance Foyer, Game, Pantry, Study
Heating: Heat Pump **Flooring:** Ceramic Tile
Fireplace Features: Family Room, One, Other (Use Remarks)



Hidden Info

List Office MLS Id: 8696

