

121 FROMAN DR, SUMMERVILLE, SC 29483, USA

https://findyourcharleston.com

121 Froman Dr,  
Summerville, SC  
29483, USA



THE BRANTLEY

3 BEDROOM | 2.5 BATH | 1,737 SQ. FT. LIVING AREA  
THE TOWNHOME SERIES



ELEVATION C

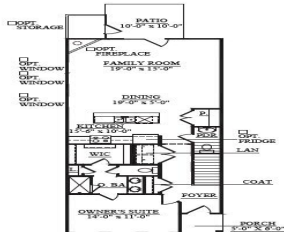

First Floor Plan  
Elevation C

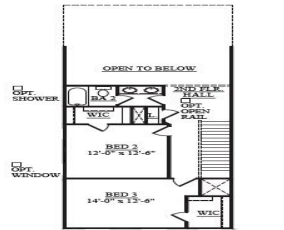

Second Floor Plan  
Elevation C

CURRENT INCENTIVES: \$5,000 off of the \$10,000+ put into options. Also, receive \$5,000 in closing cost assistance. See sales consultant for details.  
\*Incentives are tied to the use of preferred lender and closing atty.\*  
PROPOSED CONSTRUCTION. The Brantley! HERS RATED HOME! Stainless Steel appliances. Large open floorplan with 9' ceiling on first floor, eat in [...]



Mariah Ola



- 3 beds
- 2 baths
- Single Family Attached
- Residential
- Active
- 1737 sq ft

Basics



**MLS ID:** 24015156

**Category:** Residential

**Status:** Active

**Bathrooms:** 2 baths

**Area, sq ft:** 1737 sq ft

**Year built:** 2024

**County Or Parish:** Dorchester

**Date added:** Added 2 years ago

**Type:** Single Family Attached

**Bedrooms:** 3 beds

**Half baths:** 1 half bath

**Lot size, acres:** 0.05 acres

**Subdivision Name:** Sweetgrass Station

**MLS Area Major:** 63 - Summerville/Ridgeville

## Building Details

**Stories:** 2

**Parking Features:** 1 Car Garage, Garage Door Opener

**Construction Materials:** Cement Plank

**Roof:** Architectural

**New Construction Yes/ No:** 1

**Covered Spaces:** 1

**Garage Spaces:** 1

## Amenities & Features

**Water Source:** Public

**Sewer:** Public Sewer

**Cooling Yes/ No:** 1

**Interior Features:** Ceiling - Smooth, High Ceilings, Kitchen Island, Walk-In Closet(s), Entrance Foyer, Living/Dining Combo, Pantry

**Flooring:** Ceramic Tile, Laminate

**Patio & Porch Features:** Patio

**Exterior Features:** Stoop

**Cooling:** Central Air

**Heating:** Heat Pump

## Hidden Info

**List Office MLS Id:** 1240

