

111 FROMAN DR, SUMMERVILLE, SC 29483, USA

https://findyourcharleston.com

111 Froman Dr,  
Summerville, SC  
29483, USA

# THE FILMORE

3 BEDROOM | 2.5 BATH | 1,763 SQ. FT. LIVING AREA

THE TOWNHOME SERIES



\$298,215

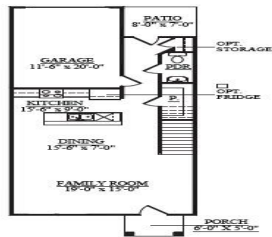

First Floor Plan Elevation A

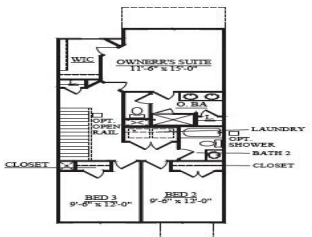

Second Floor Plan Elevation A



SWEETGRASS PRELIMINARY AMENITY CONCEPT DANIELIAN

CURRENT INCENTIVES: \$5,000 off of the \$10,000+ put into options. Also, receive \$5,000 in closing cost assistance. See sales consultant for details. \*Incentives are tied to the use of preferred lender and closing atty.\* PROPOSED CONSTRUCTION. The Filmore! HERS RATED HOME! Stainless Steel appliances. Large open floorplan with 9' ceilings on the first floor, eat [...]

- 3 beds
- 2 baths
- Single Family Attached
- Residential
- Active
- 1558 sq ft



Mariah Ola



---

## Basics

**MLS ID:** 24015159

**Category:** Residential

**Status:** Active

**Bathrooms:** 2 baths

**Area, sq ft:** 1558 sq ft

**Year built:** 2024

**County Or Parish:** Dorchester

**Date added:** Added 6 months ago

**Type:** Single Family Attached

**Bedrooms:** 3 beds

**Half baths:** 1 half bath

**Lot size, acres:** 0.05 acres

**Subdivision Name:** Sweetgrass Station

**MLS Area Major:** 63 - Summerville/Ridgeville

---

## Building Details

**Stories:** 2

**Parking Features:** 1 Car Garage, Garage Door Opener

**Construction Materials:** Cement Plank

**Roof:** Architectural

**New Construction Yes/ No:** 1

**Covered Spaces:** 1

**Garage Spaces:** 1

---

## Amenities & Features

**Water Source:** Public

**Sewer:** Public Sewer

**Cooling Yes/ No:** 1

**Interior Features:** Ceiling - Smooth, High Ceilings, Kitchen Island, Walk-In Closet(s), Living/Dining Combo, Pantry

**Flooring:** Ceramic Tile, Laminate

**Patio & Porch Features:** Patio

**Exterior Features:** Stoop

**Cooling:** Central Air

**Heating:** Heat Pump

---

## Hidden Info

**List Office MLS Id:** 1240

