

169 MARSH ISLAND DR, JOHNS ISLAND, SC 29455, USA

<https://findyourcharleston.com>

169 Marsh Island
Dr, Johns Island, SC
29455, USA



\$2,990,000

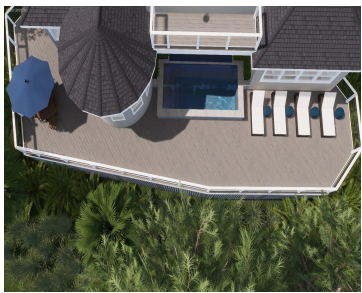

Marsh front Serenity with Kiawah Island Club Social Membership Opportunity and room for a Pool.Set on a quiet dead-end street, this marsh front retreat offers unimpeded views of the Kiawah River and breathtaking sunsets. With 3,941 sq. ft. of inviting space, this comfortable 5-bedroom, 4-bathroom home blends open design with natural light, courtesy of floor-to-ceiling [...]



Toula Digiovanni

- 5 beds
- 4 baths
- Single Family Detached
- Residential
- Active
- 3941 sq ft



Basics



MLS ID: 24027605

Category: Residential

Status: Active

Bathrooms: 4 baths

Lot size, acres: 0.37 acres

Subdivision Name: Marsh Island Woods 427

MLS Area Major: 25 - Kiawah

Date added: Added 7 months ago

Type: Single Family Detached

Bedrooms: 5 beds

Area, sq ft: 3941 sq ft

Year built: 1994

County Or Parish: Charleston

Building Details

Stories: 2

Covered Spaces: 2

Accessibility Features: Handicapped Equipped

Roof: Architectural

Parking Features: 2 Car Garage, Off Street, Other, Garage Door Opener

Construction Materials: Stucco

Garage Spaces: 2

Amenities & Features

Water Source: Public

Architectural Style: Contemporary

Exterior Features: Lawn Irrigation

Waterfront Features: Marshfront

Cooling: Central Air

Heating: Central, Electric, Forced Air

Fireplace Features: Gas Connection, Great Room, Two

Patio & Porch Features: Deck, Front Porch

Sewer: Public Sewer

Cooling Yes/ No: 1

Window Features: Thermal Windows/Doors, Window Treatments

Interior Features: Ceiling - Smooth, High Ceilings, Garden Tub/Shower, Kitchen Island, Walk-In Closet(s), Ceiling Fan(s), Entrance Foyer, Great

Flooring: Carpet, Ceramic Tile, Wood

Hidden Info



