

228 DONATELLA DR, GOOSE CREEK, SC 29445, USA

https://findyourcharleston.com

228 Donatella Dr,
Goose Creek, SC
29445, USA

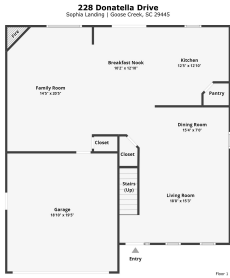

Freshly painted 4 bedroom home in Sophia Landing. This one checks all the boxes with a picturesque pond view, neighborhood play park and swimming pool amenity, and convenient location off Hwy 52 and Henry E. Brown, Jr. Blvd. Open floor plan downstairs with foyer entry, flexible living room space, stylish dining area with wainscoting and [...]

- 4 beds
- 2 baths
- Single Family Detached
- Residential
- Active
- 2686 sq ft



Jim Hamilton



Basics



MLS ID: 25013937

Category: Residential

Status: Active

Bathrooms: 2 baths

Area, sq ft: 2686 sq ft

Year built: 2011

County Or Parish: Berkeley

Date added: Added 8 months ago

Type: Single Family Detached

Bedrooms: 4 beds

Half baths: 1 half bath

Lot size, acres: 0.15 acres

Subdivision Name: Sophia Landing

MLS Area Major: 72 - G.Cr/M. Cor. Hwy 52-Oakley-Cooper River

Building Details

Stories: 2

Entry Location: Ground Level

Construction Materials: Stone Veneer, Vinyl Siding

Roof: Asphalt, Fiberglass

Parking Features: 2 Car Garage, Attached, Garage Door Opener

Covered Spaces: 2

Garage Spaces: 2

Amenities & Features

Water Source: Public

Architectural Style: Traditional

Exterior Features: Rain Gutters

Waterfront Features: Pond

Attached Garage Yes/ No: 1

Heating: Central

Fireplace Features: Family Room, Gas Log, One

Patio & Porch Features: Patio, Front Porch

Sewer: Public Sewer

Cooling Yes/ No: 1

Cooling: Central Air

Interior Features: Ceiling - Smooth, High Ceilings, Garden Tub/Shower, See Remarks, Walk-In Closet(s), Bonus, Eat-in Kitchen, Family, Formal Living, Loft, Other, Pantry, Separate Dining

Flooring: Carpet, Vinyl

Hidden Info



