

# 229 CELESTIAL BLVD, MONCKS CORNER, SC 29461, USA

<https://findyourcharleston.com>

229 Celestial Blvd,  
Moncks Corner, SC  
29461, USA



\$475,000

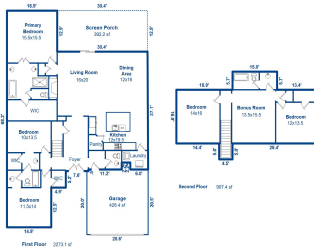

Welcome to the pinnacle of luxury living in the coveted Meridian subsection of Cane Bay! Upon entering through the front door, you are greeted by an expansive foyer that leads to a spacious open-concept living area. The kitchen, a culinary masterpiece, boasts a gas range, stylish tile backsplash, granite countertops, and an expansive island-the perfect [...]

- 5 beds
- 3 baths
- Single Family Detached
- Residential
- Active
- 3170 sq ft



Jenn Stevens

## Basics



**MLS ID:** 25003787

**Category:** Residential

**Status:** Active

**Bathrooms:** 3 baths

**Area, sq ft:** 3170 sq ft

**Year built:** 2020

**County Or Parish:** Berkeley

**Date added:** Added 7 months ago

**Type:** Single Family Detached

**Bedrooms:** 5 beds

**Half baths:** 1 half bath

**Lot size, acres:** 0.18 acres

**Subdivision Name:** Cane Bay Plantation

**MLS Area Major:** 74 - Summerville, Ladson, Berkeley Cty

## Building Details

**Stories:** 2

**Entry Location:** Ground Level

**Construction Materials:** Vinyl Siding

**Roof:** Architectural, Asphalt

**Parking Features:** 1 Car Garage, 1.5 Car Garage, 2 Car Garage, Attached, Off Street, Garage Door Opener

**Covered Spaces:** 4.5

**Garage Spaces:** 4.5

## Amenities & Features

**Water Source:** Public

**Architectural Style:** Traditional

**Cooling Yes/ No:** 1

**Cooling:** Central Air

**Interior Features:** Ceiling - Smooth, Garden Tub/Shower, Kitchen Island, Walk-In Closet(s), Ceiling Fan(s), Bonus, Family, Game, Living/Dining Combo, Loft, Pantry

**Flooring:** Carpet, Laminate

**Fencing:** Fence - Wooden Enclosed

**Patio & Porch Features:** Screened

**Sewer:** Public Sewer

**Window Features:** Window Treatments - Some

**Attached Garage Yes/ No:** 1

**Heating:** Central

**Fireplace Features:** Living Room, One

## Hidden Info



