

3016 BRILEY CT, MT PLEASANT, SC 29466, USA

<https://findyourcharleston.com>

3016 Briley Ct, Mt Pleasant, SC 29466, USA

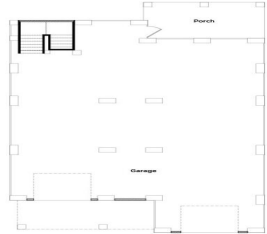

The Rosecroft currently under construction with an estimated completion late 2024! The Rosecroft is a excellent drive under plan with a owner's suite on the main level and open floor plan featuring 20ft ceilings in the family room!. Upstairs you will 3 large bedrooms, 2 baths and a generous loft space to use as a [...]



Jonathan Miller

- 4 beds
- 3 baths
- Single Family Detached
- Residential
- Active
- 3436 sq ft

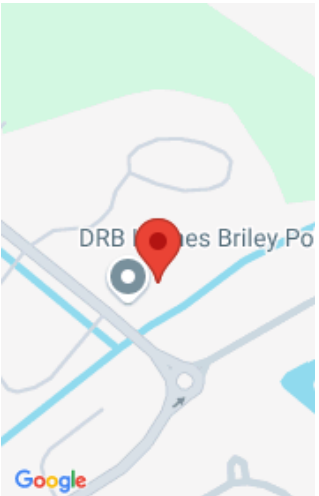

Basics

MLS ID: 24015622 **Date added:** Added 5 months ago
Category: Residential **Type:** Single Family Detached
Status: Active **Bedrooms:** 4 beds
Bathrooms: 3 baths **Half baths:** 1 half bath
Area, sq ft: 3436 sq ft **Lot size, acres:** 0.37 acres
Year built: 2024 **Subdivision Name:** None
County Or Parish: Charleston **MLS Area Major:** 41 - Mt Pleasant N of IOP Connector

Building Details

Stories: 2 **New Construction Yes/ No:** 1
Parking Features: 3 Car Garage **Covered Spaces:** 3
Construction Materials: Cement Plank **Garage Spaces:** 3
Roof: Architectural, Metal

Amenities & Features

Water Source: Public **Patio & Porch Features:**
Porch - Full Front
Architectural Style: Traditional **Sewer:** Public Sewer
Exterior Features: Lawn Irrigation **Cooling Yes/ No:** 1
Window Features: ENERGY STAR Qualified Windows **Cooling:** Central Air
Interior Features: Ceiling - Cathedral/Vaulted, Ceiling -
Smooth, High Ceilings, Kitchen Island, Walk-In Closet(s), Wet
Bar, Family, Entrance Foyer, Loft, Pantry, Separate Dining **Heating:** Natural Gas
Flooring: Ceramic Tile, Wood **Fireplace Features:** Family
Room

Hidden Info



