

QPC9+FJ RAVENEL, SC, USA

<https://findyourcharleston.com>

QPC9+FJ Ravenel, SC, USA

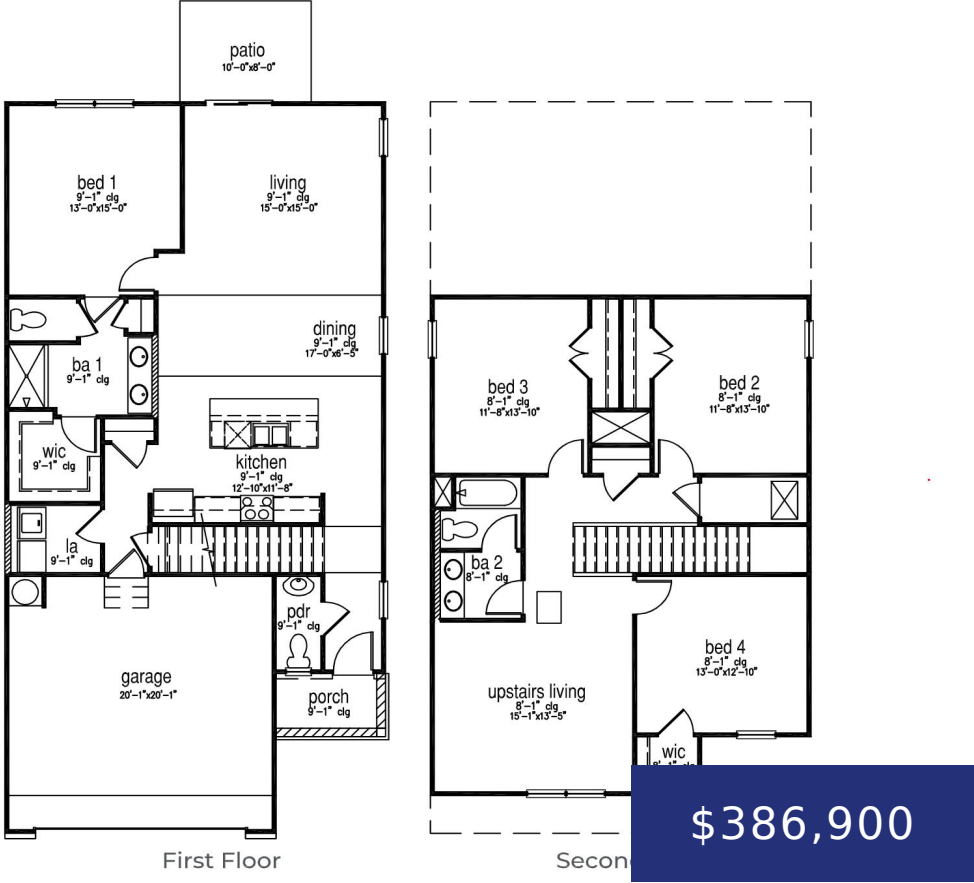

READY THIS FALL! This homesite is back-to-back with an adjacent home. Hillcrest is tucked away in a quiet, true Lowcountry environment, tucked away from the hustle and bustle of the city. Conveniently located off Highway 17, this community gives direct access to everything that makes Charleston such a great place to live! Here you are, [...]

- 4 beds
- 2 baths
- Single Family Detached
- Residential
- Active Contingent
- 2203 sq ft



Katie Stevens Grout

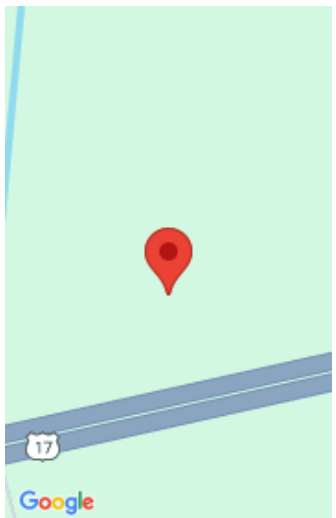

Basics

MLS ID: 24013734 **Date added:** Added 6 months ago
Category: Residential **Type:** Single Family Detached
Status: Active Contingent **Bedrooms:** 4 beds
Bathrooms: 2 baths **Half baths:** 1 half bath
Area, sq ft: 2203 sq ft **Lot size, acres:** 0.15 acres
Year built: 2024 **Subdivision Name:** Hillcrest
County Or Parish: Charleston **MLS Area Major:** 13 - West of the Ashley beyond Rantowles Creek

Building Details

Stories: 2 **New Construction Yes/ No:** 1
Parking Features: 2 Car Garage **Covered Spaces:** 2
Construction Materials: Cement Plank **Garage Spaces:** 2
Roof: Fiberglass

Amenities & Features

Water Source: Public **Patio & Porch Features:**
Patio
Architectural Style: Traditional **Sewer:** Public Sewer
Exterior Features: Stoop **Cooling Yes/ No:** 1
Window Features: Window Treatments **Cooling:** Central Air
Interior Features: Ceiling - Smooth, Kitchen Island, Walk-In Closet(s), Bonus, Eat-in Kitchen, Family, Entrance Foyer, Living/Dining Combo, Pantry **Heating:** Electric
Flooring: Vinyl

Hidden Info



