

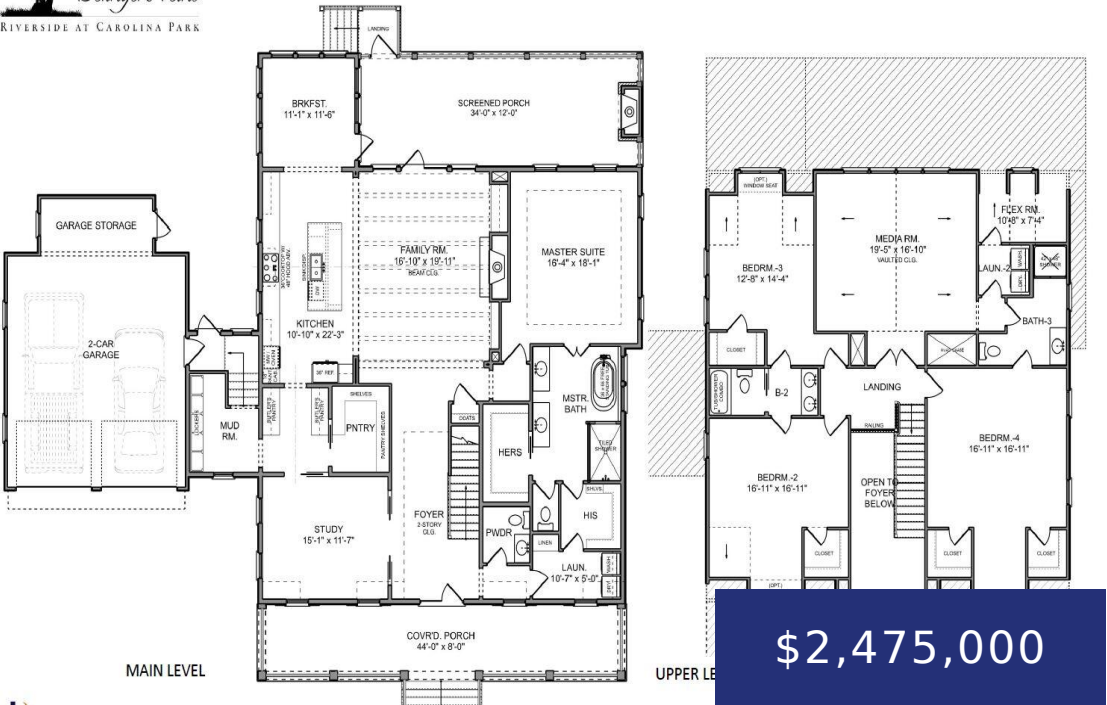

THE MOULTRIE

4,123 SQ. FT. | 4 BEDROOMS | 3.5 BATHS



Under Construction, estimated completion date June/July 2025. Welcome to our exclusive enclave in Riverside, where we build architecturally distinct, custom homes. 3846 Delinger Drive is the epitome of elegance on a .52 acre spacious, marshfront lot. The highlights of this 4 BDRM, 3.5BA stunner include a spacious entryway that has clear sight lines to the rear [...]

- 4 beds
- 3 baths
- Single Family Detached
- Residential
- Active
- 4123 sq ft



Haley Cuzzell



Patty Lynn Connell



# Basics

**MLS ID:** 25006488

**Category:** Residential

**Status:** Active

**Bathrooms:** 3 baths

**Area, sq ft:** 4123 sq ft

**Year built:** 2025

**County Or Parish:** Charleston

**Date added:** Added 9 months ago

**Type:** Single Family Detached

**Bedrooms:** 4 beds

**Half baths:** 1 half bath

**Lot size, acres:** 0.52 acres

**Subdivision Name:** Carolina Park

**MLS Area Major:** 41 - Mt Pleasant N of IOP Connector

# Building Details

**Stories:** 2

**Parking Features:** 2 Car Garage, Attached, Garage Door Opener

**Construction Materials:** Cement Siding

**Roof:** Metal

**New Construction Yes/ No:** 1

**Covered Spaces:** 2

**Garage Spaces:** 2

# Amenities & Features

**Water Source:** Public

**Architectural Style:** Traditional

**Exterior Features:** Dock - Existing, Dock - Shared, Lawn Irrigation

**Waterfront Features:** Marshfront

**Attached Garage Yes/ No:** 1

**Heating:** Heat Pump

**Fireplace Features:** Family Room, Gas Log, Other, Two

**Patio & Porch Features:** Front Porch, Screened

**Sewer:** Public Sewer

**Cooling Yes/ No:** 1

**Cooling:** Central Air

**Interior Features:** Ceiling - Smooth, High Ceilings, Garden Tub/Shower, Kitchen Island, Walk-In Closet(s), Ceiling Fan(s), Eat-in Kitchen, Family, Entrance Foyer, Media, Office, Pantry, Separate Dining

**Flooring:** Carpet, Ceramic Tile, Wood





# Hidden Info

List Office MLS Id: 1385

