

118 JESUP CT, RIDGEVILLE, SC 29472, USA

<https://findyourcharleston.com>

118 Jesup Ct,
Ridgeville, SC
29472, USA

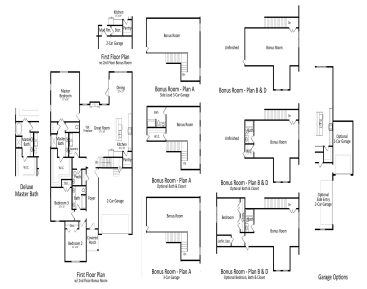

PROPOSED CONSTRUCTION: Introducing the Putnam at Timothy Lakes. Find your very own slice of paradise in the community of Timothy Lakes. Located near I-26 in Ridgeville, SC, Timothy Lakes is close in proximity to various local and new businesses such as Volvo as well as a convenient drive to downtown Summerville. Experience the tranquility and [...]



Shane Ford

- 3 beds
- 2 baths
- Single Family Detached
- Residential
- Active
- 2298 sq ft

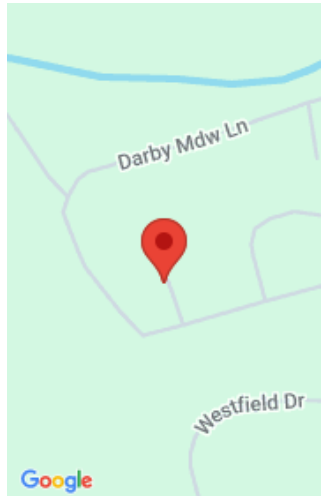

Basics

MLS ID: 22018508

Category: Residential

Status: Active

Bathrooms: 2 baths

Area, sq ft: 2298 sq ft

Year built: 2025

County Or Parish: Dorchester

Date added: Added 6 months ago

Type: Single Family Detached

Bedrooms: 3 beds

Half baths: 1 half bath

Lot size, acres: 0.33 acres

Subdivision Name: Timothy Lakes

MLS Area Major: 63 - Summerville/Ridgeville

Building Details

Stories: 1

Entry Location: Ground Level

Construction Materials: Vinyl Siding

Roof: Architectural

Parking Features: 2 Car Garage, Attached

Covered Spaces: 2

Garage Spaces: 2

Amenities & Features

Water Source: Public

Architectural Style: Traditional

Exterior Features: Lawn Irrigation

Window Features: Thermal
Windows/Doors

Attached Garage Yes/ No: 1

Heating: Natural Gas

Patio & Porch Features: Patio, Covered

Sewer: Public Sewer

Cooling Yes/ No: 1

Cooling: Central Air

Interior Features: Ceiling - Smooth, High
Ceilings, Kitchen Island, Walk-In Closet(s), Family,
Entrance Foyer, Pantry, Separate Dining

Flooring: Ceramic Tile, Laminate

Hidden Info



