

4006 OLD BRIDGEVIEW LN, CHARLESTON, SC 29403, USA

https://findyourcharleston.com

4006 Old
Bridgeview Ln,
Charleston, SC
29403, USA

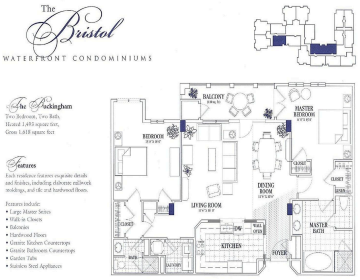

Light and bright penthouse condo with a view of Brittlebank Park highlights beautiful Brazilian Walnut hardwood floors throughout with no thresholds and lots of built-in storage. Hardware in the condo is oil rubbed bronze. Master bath has stone flooring and a roll-in European shower for easy cleaning, and perfect if needed for handicapped. The galley [...]

- 2 beds
- 2 baths
- Single Family Attached
- Residential
- Active
- 1498 sq ft



Marilynn Durkee

Basics



MLS ID: 25007603

Category: Residential

Status: Active

Bathrooms: 2 baths

Area, sq ft: 1498 sq ft

Year built: 2002

County Or Parish: Charleston

Date added: Added 7 months ago

Type: Single Family Attached

Bedrooms: 2 beds

Half baths: 0 half baths

Lot size, acres: 0.3 acres

Subdivision Name: The Bristol

MLS Area Major: 52 - Peninsula Charleston Outside of Crosstown

Building Details

Stories: 5

Security Features: Fire Sprinkler System

Construction Materials: Block, Brick Veneer, Stucco

Roof: See Remarks

Parking Features: 2 Car Garage, Attached, Off Street, Other, Garage Door Opener

Covered Spaces: 2

Garage Spaces: 2

Amenities & Features

Water Source: Public

Sewer: Public Sewer

Door Features: Storm Door(s)

Waterfront Features: River Front, Waterfront - Deep, Waterfront - Shallow

Cooling: Central Air

Interior Features: Ceiling - Smooth, Tray Ceiling(s), High Ceilings, Garden Tub/Shower, Walk-In Closet(s), Ceiling Fan(s), Living/Dining Combo

Flooring: Stone, Wood

Fencing: Wrought Iron

Pool Features: Above Ground, Pool - Elevated

Exterior Features: Balcony, Dock - Shared, Elevator Shaft

Cooling Yes/ No: 1

Window Features: Storm Window(s)

Attached Garage Yes/ No: 1

Heating: Heat Pump

Fireplace Features: Gas Log, Living Room, One





Hidden Info

List Office MLS Id: 9048

