

# 619 KING ST, CHARLESTON, SC 29403, USA

<https://findyourcharleston.com>

619 King St,  
Charleston, SC  
29403, USA

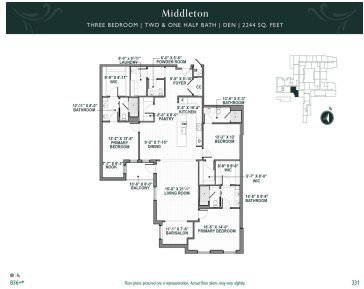

### AMENITIES

The amenities and programming will be exclusive to the Members of The Peninsula of Charleston. Our location in historic Charleston enhances your experience, providing easy access to nearby arts, cultural offerings, shopping, fine dining and all the great things Charleston has to offer.

- Fitness & Wellness Center
- Recreational, Social, Educational and Cultural Programs
- Saltwater Pool
- Spa & Salon
- Formal Dining
- Informal Dining
- Grab & Go Cafe
- Golf Simulator
- Club Lounge & Bar
- Fourth Floor Terrace Club Lounge
- 24 Hour Concierge
- Complimentary Valet Parking
- 24/7 Security
- Private Dining Room
- Card Room
- Theaters
- Library
- Ball Room
- Priority Access to On-Site Healthcare
- Pet Friendly Park
- Grill Area
- Full Healthcare Continuum

Coming in 2026! The Peninsula of Charleston is an ownership-model, continuing care retirement community (CCRC) on highly desirable upper King Street in historic downtown Charleston. Resident members will have full access to more than 40,000 square feet of luxurious amenities, as well as peace of mind knowing that as a Life Plan Community, The Peninsula [...]

- 3 beds
- 2 baths
- Single Family Attached
- Residential
- Active
- 2244 sq ft



**Perry Aycock**

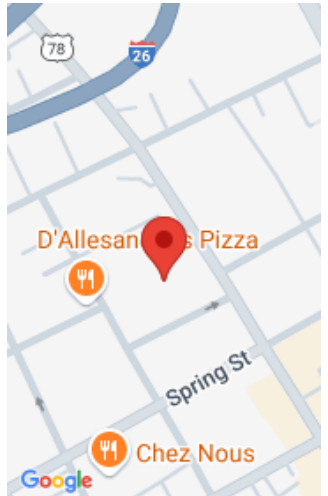

---

## Basics

**MLS ID:** 24015089      **Date added:** Added 5 months ago  
**Category:** Residential      **Type:** Single Family Attached  
**Status:** Active      **Bedrooms:** 3 beds  
**Bathrooms:** 2 baths      **Half baths:** 1 half bath  
**Area, sq ft:** 2244 sq ft      **Lot size, acres:** 2.3 acres  
**Year built:** 2026      **Subdivision Name:** City of Charleston  
**County Or Parish:** Charleston      **MLS Area Major:** 51 - Peninsula Charleston Inside of Crosstown

---

## Building Details

**Stories:** 7      **Parking Features:** Other (Use Remarks), Garage Door Opener  
**Security Features:** Fire Sprinkler System      **Entry Location:** Ground Level  
**Construction Materials:** Brick      **Roof:** Architectural

---

## Amenities & Features

**Water Source:** Public      **Patio & Porch Features:** Patio  
**Pool Features:** In Ground, Indoor      **Exterior Features:** Balcony, Lawn Irrigation  
**Cooling Yes/ No:** 1      **Cooling:** Central Air  
**Interior Features:** Elevator, Kitchen Island, Walk-In Closet(s), Ceiling Fan(s), Entrance Foyer, Great, Office, Other (Use Remarks), Study      **Heating:** Forced Air  
**Flooring:** Ceramic Tile, Wood

---

## Hidden Info

**List Office MLS Id:** 10435

