

615 FLINT ST, CHARLESTON, SC 29412, USA

https://findyourcharleston.com

615 Flint St,
Charleston, SC
29412, USA



ELEVATION B

\$1,180,803

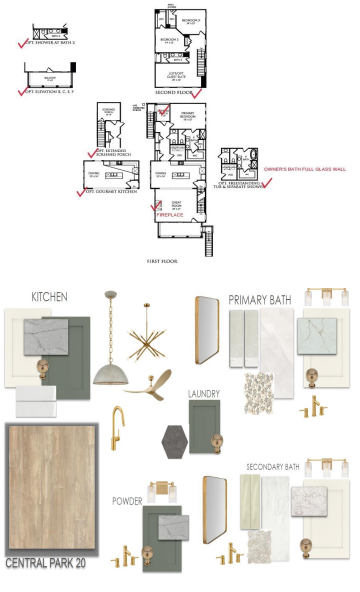

PROPOSED CONSTRUCTION; LOT 20The Monroe floorplan: Nestled in the heart of James Island and situated in a pocket style community, this beautifully crafted Drive under home is designed with thoughtful craftsmanship and sophisticated finishes throughout. It will not only boast a primary bedroom on the 1st floor but also a Guest Suite on the 2nd [...]



Maressa Williams

- 3 beds
- 3 baths
- Single Family Detached
- Residential
- Active
- 2356 sq ft



Basics



MLS ID: 25007665
Category: Residential
Status: Active
Bathrooms: 3 baths
Area, sq ft: 2356 sq ft
Year built: 2025
County Or Parish: Charleston

Date added: Added 9 months ago
Type: Single Family Detached
Bedrooms: 3 beds
Half baths: 1 half bath
Lot size, acres: 0.07 acres
Subdivision Name: Central Park
MLS Area Major: 21 - James Island

Building Details

Stories: 2	Parking Features: 2 Car Garage, Garage Door Opener
Covered Spaces: 2	Construction Materials: Cement Siding
Garage Spaces: 2	Roof: Architectural, Metal

Amenities & Features

Water Source: Public	Patio & Porch Features: Front Porch, Screened
Architectural Style: Traditional	Sewer: Public Sewer
Exterior Features: Rain Gutters	Cooling Yes/ No: 1
Window Features: Window Treatments	Interior Features: High Ceilings, Garden Tub/Shower, Kitchen Island, Walk-In Closet(s), Ceiling Fan(s), Great, Living/Dining Combo, Pantry
Heating: Natural Gas	Flooring: Ceramic Tile, Luxury Vinyl
Fireplace Features: Great Room, One	

Hidden Info

List Office MLS Id: 10811

